

## Motors of the 7AA 56 – 90 series

IM B5

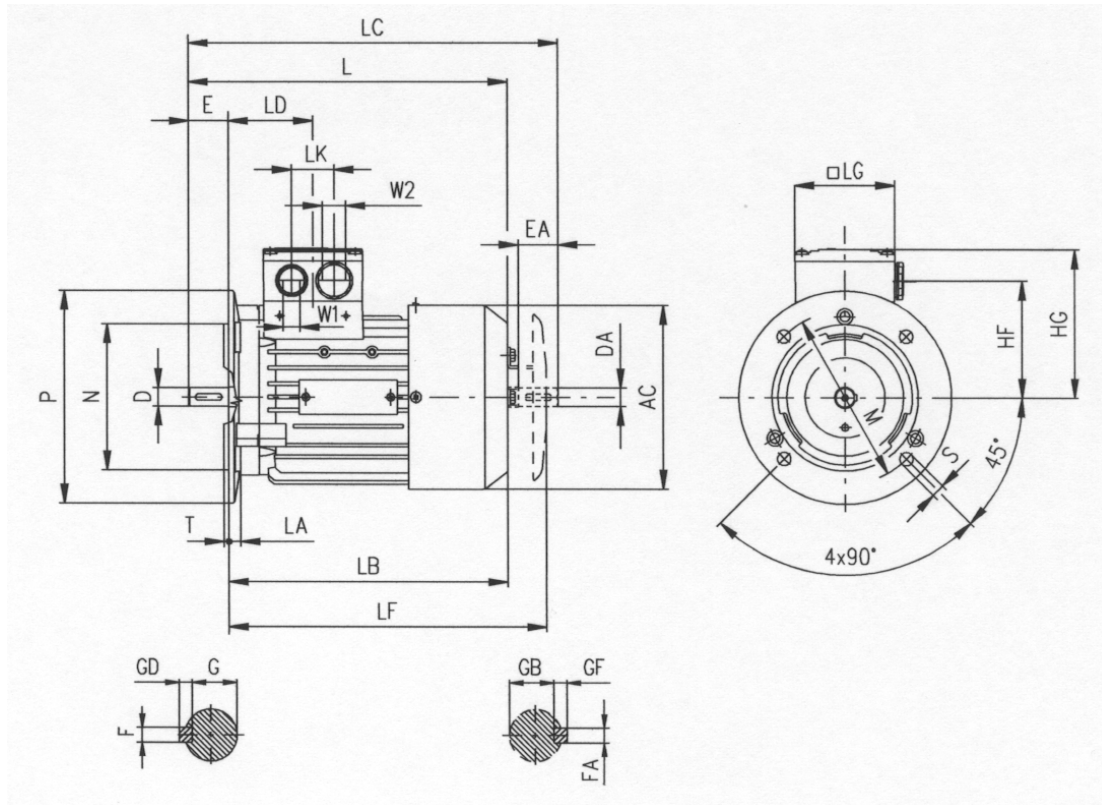

Frame Size	Flange Size	AC	HF	HG	L	LA	LB	LC	LD	LF	LG	LK	M	N
<b>56</b>	FF100	116	77,5	101	169,5	8	149,5	200	69,5	-	75	32	100	80
<b>63</b>	FF115	118	77,5	101	202,5	8	179,5	232	69,5	208,5	75	32	115	95
<b>71</b>	FF130	139	87,5	111	240,0	9	210,0	278	63,5	239,0	75	32	130	110
<b>80</b>	FF165	156,5	96,5	120	173,5	10	233,5	324	63,5	262,5	75	32	165	130
<b>90</b>	FF165	173,6	104,5	128	331,0	10	281,0	389	79,0	333,0	75	32	165	130

Frame Size	P	S	T	W1/W2	D	DA	E	EA	F	FA	G	GB	GD	GF
<b>56</b>	120	7	3,0	M16/M25	9	9	20	20	3	3	7,2	7,2	3	3
<b>63</b>	140	10	3,0	M16/M25	11	11	23	23	4	4	8,5	8,5	4	4
<b>71</b>	160	10	3,5	M16/M25	14	14	30	30	5	5	11,0	11,0	5	5
<b>80</b>	200	12	3,5	M16/M25	19	19	40	40	6	6	15,5	15,5	6	6
<b>90</b>	200	12	3,5	M16/M25	24	19	50	40	8	6	20,0	15,5	7	6

The limit deviations of tolerated dimensions : N= j6,5, D = k6, F= h9

Other limit deviations according to CSN 35 0049, CSN IEC 72-1, not stated in 2 IT 15

A tapped hole in the shaft drive end is according to DIN 332.