



MOTOREN DESMEDT NV

Moerelei 145, B-2610 Antwerpen, Belgium
+32-(0)3-830.09.90 +32-(0)3-828.78.90
info@motorendesmedt.be

MOTEURS TRIPHASES ASYNCHRONES, IP 23 TAILLES 160 à 355



EUROPEAN ELECTRIC COMPANY

SPECIFICATIONS 2p 3000 t/m (50Hz)

Motor Type	Rated Power KW Puissance	Current A Amp		Speed Vitesse r/min	Full load Pleine charge Power Factor Facteur de puissance COS	Efficiency Efficience	Locked Current/ Rated Current C ^d /C ⁿ	Locked Torque/ Rated Torque C ^d /C ⁿ	Maximum Torque/ Rated Torque C ^m /C ^d	Moment of inertia J kgm	Weight Poids kg
		380V	400V								
		OV 160M2	15								
OV 160L2	18.5	35.1	33.3	2925	0.88	91.0	6.8	2.1	2.6	0.068	141
OV 160LX2	22	43.6	41.4	2925	0.87	88.2	7.0	2.1	2.6	0.070	152
OV 180M2	30	56.6	53.7	2935	0.89	90.8	7.0	2.2	2.8	0.125	210
OV 180L2	37	69.3	65.8	2940	0.89	91.2	7.0	2.2	2.8	0.135	222
OV 200M2	45	83.7	79.5	2945	0.89	91.8	7.0	2.1	2.7	0.188	285
OV 200L2	55	102	97.3	2945	0.89	91.7	7.0	2.1	2.7	0.210	297
OV 225M2	75	138	131	2950	0.89	92.5	7.2	2.1	2.8	0.362	367
OV 250S2	90	163	154	2960	0.90	93.5	7.5	2.4	3.0	0.531	507
OV 250M2	110	197	187	2965	0.90	94.5	7.5	2.4	3.0	0.584	543
OV 280M2	132	234	223	2960	0.91	94.0	7.5	2.2	3.0	0.793	700
OV 315S2(A)	160	289	275	2970	0.89	94.4	6.5	1.6	2.8	1.592	942
OV 315M2(A)	200	371	352	2965	0.87	94.2	7.2	1.6	2.8	1.751	970
OV 315LA2(A)	250	463	439	2965	0.87	94.4	7.2	1.6	2.8	1.935	1035
OV 315LB2(A)	280	495	471	2970	0.90	95.4	7.0	1.8	2.8	2.177	1084
OV 315LX2(A)	315	556	528	2970	0.90	95.6	7.0	1.9	3.0	2.503	1180
OV 315 LY2(B)	355	649	617	2965	0.87	95.5	7.0	1.5	2.1	2.629	1286
OV 315LZA2(B)	400	696	662	2970	0.91	95.9	7.0	1.8	3.0	2.997	1350
OV 315LZB2(B)	450	823	782	2970	0.87	95.5	7.0	1.5	2.1	3.145	1420
OV 355M2	500	860	817	2970	0.92	96.0	6.5	1.3	2.7	4.500	1620
OV 355L2	630	1084	1030	2970	0.92	96.0	6.5	1.3	2.7	5.340	1855
OV 355LX2	710	1221	1160	2970	0.92	96.0	6.5	1.3	2.7	5.340	1880

SPECIFICATIONS 4p 1500 t/m (50Hz)

Motor Type	Rated Power KW Puissance	Current A Amp		Speed Vitesse r/min	Full load Pleine charge Power Factor Facteur de puissance COS	Efficiency Efficience	Locked Current/ Rated Current C ^d /C ⁿ	Locked Torque/ Rated Torque C ^d /C ⁿ	Maximum Torque/ Rated Torque C ^m /C ^d	Moment of inertia J kgm	Weight Poids kg
		380V	400V								
		OV 160M4	11								
OV 160L4	15	30.2	28.7	1460	0.84	89.8	6.5	2.0	2.5	0.128	142
OV 160LX4	18.5	36.8	35.0	1460	0.84	90.9	7.0	2.2	2.5	0.130	154
OV 180M4	22	41.6	39.6	1460	0.88	91.2	7.5	2.7	3.2	0.224	206
OV 180L4	30	59.0	53.5	1460	0.88	91.9	7.5	2.7	3.2	0.266	226
OV 200M4	37	71.3	67.7	1465	0.86	91.7	6.5	2.1	2.6	0.328	297
OV 200L4	45	86.4	82.1	1465	0.86	92.0	6.5	2.1	2.6	0.620	311
OV 225M4	55	102	97.0	1470	0.88	93.0	7.0	2.4	3.0	0.945	389
OV 250S4	75	139	132	1475	0.88	93.1	7.0	2.4	3.0	1.032	524
OV 250M4	90	164	156	1475	0.89	93.5	7.2	2.4	3.0	1.546	551
OV 280S4	110	197	187	1475	0.90	94.4	7.4	2.6	3.2	1.764	735
OV 280M4	132	238	226	1475	0.90	93.5	7.0	2.4	3.0	3.212	742
OV 315S4(A)	160	295	280	1480	0.87	94.8	6.2	1.7	2.5	3.074	968
OV 315M4(A)	200	367	349	1480	0.87	95.2	6.2	1.7	2.5	3.744	1064
OV 315LA4(A)	250	453	430	1480	0.88	95.3	6.2	1.7	2.5	4.481	1165
OV 315LB4(A)	280	512	486	1475	0.87	95.6	6.0	1.6	2.4	4.446	1205
OV 315LX4(B)	315	567	539	1480	0.88	95.9	6.5	1.8	2.6	5.126	1364
OV 315LY4(B)	355	646	614	1480	0.87	96.0	7.0	1.9	2.8	6.090	1498
OV 315LZB4(B)	400	748	710	1480	0.86	94.5	6.7	1.6	2.4	6.211	1506
OV 355S4	450	827	786	1485	0.87	95.0	6.0	1.4	2.3	8.480	1750
OV 355M4	500	914	869	1485	0.87	95.5	6.0	1.4	2.3	9.170	1790
OV 355MX4	560	1012	962	1485	0.88	95.5	6.0	1.4	2.3	10.49	1945
OV 355L4	630	1145	1088	1485	0.88	95.0	6.5	1.6	2.5	12.08	2095
OV 355LX4	710	1277	1213	1485	0.88	96.0	6.5	1.6	2.5	12.08	2130

SPECIFICATIONS 6p 1000 t/m (50Hz)

Motor Type	Rated Power KW Puissance	Current A Amp		Full load Pleine charge		Power Factor Facteur de puissance COS	Efficiency Efficience	Locked Current/ Rated Current C ^d /C ⁿ	Locked Torque/ Rated Torque C ^d /C ⁿ	Maximum Torque/ Rated Torque C ^m /C ^d	Moment of inertia J kgm	Weight Poids kg
		380V	400V	Speed Vitesse r/min								
OV 160LX6	11	24.7	23.4	975	0.77	88.0	6.0	1.8	2.5	0.162	141	
OV 180M6	15	31.6	30.0	975	0.81	89.0	6.0	2.3	2.8	0.231	198	
OV 180L6	18.5	38.1	36.2	975	0.82	90.0	6.0	2.3	2.8	0.256	212	
OV 200M6	22	44.9	42.7	980	0.82	90.7	6.5	2.1	2.7	0.342	262	
OV 200L6	30	61.0	57.9	980	0.82	91.2	6.5	2.1	2.7	0.402	279	
OV 225M6	37	71.4	67.8	980	0.86	91.6	6.5	2.1	2.7	0.632	343	
OV 250S6	45	88.9	84.4	985	0.84	91.6	6.5	2.2	2.8	0.834	473	
OV 250M6	55	108	103	985	0.84	91.8	6.5	2.2	2.8	0.894	490	
OV 280S6	75	148	140	985	0.83	93.0	6.0	2.0	2.5	1.421	675	
OV 280M6	90	174	165	985	0.84	93.6	6.0	2.0	2.5	1.853	745	
OV 315S6(A)	110	216	206	988	0.82	94.2	5.5	1.6	2.4	3.378	925	
OV 315M6(A)	132	259	246	988	0.82	94.6	5.5	1.7	2.4	3.961	965	
OV 315MX6(A)	160	316	300	988	0.81	95.0	6.0	1.8	2.5	4.804	1083	
OV 315LA6(A)	180	351	334	988	0.82	95.0	6.0	1.8	2.5	5.187	1127	
OV 315LB6(A)	200	385	366	988	0.83	95.0	6.0	1.8	2.5	5.727	1165	
OV 315LX6(B)	225	433	411	988	0.83	95.2	6.0	1.8	2.5	6.309	1335	
OV 315LY6(B)	250	481	457	988	0.83	95.2	6.0	1.9	2.5	7.022	1371	
OV 315LZB6(B)	280	538	511	988	0.83	95.2	6.0	1.9	2.5	7.888	1462	
OV 355S6	315	618	587	988	0.82	94.5	5.0	1.5	1.9	7.910	1620	
OV 355M6	355	692	658	988	0.82	95.0	5.3	1.6	2.0	9.330	1730	
OV 355MX6	400	780	741	988	0.82	95.0	5.5	1.6	2.0	9.330	1770	
OV 355MY6	450	878	834	988	0.82	95.0	5.5	1.6	2.0	10.74	1925	
OV 355L6	500	970	922	988	0.82	95.5	6.0	1.7	2.2	12.25	2075	

SPECIFICATIONS 8p 750 t/m (50Hz)

Motor Type	Rated Power KW Puissance	Current A Amp		Speed Vitesse r/min	Full load Pleine charge Power Factor Facteur de puissance COS	Efficiency Efficience	Locked Current/ Rated Current C ^d /C ⁿ	Locked Torque/ Rated Torque C ^d /C ⁿ	Maximum Torque/ Rated Torque C ^m /C ^d	Moment of inertia J kgm	Weight Poids kg
		380V	400V								
		OV 180M8	11								
OV 180L8	15	35	33	715	0.77	84.5	4.5	1.8	2.1	0.260	200
OV 200M8	18	43	41	720	0.77	84.5	4.5	1.8	2.1	0.340	240
OV 200L8	22	50	48	720	0.77	86.0	4.5	1.8	2.1	0.370	250
OV 225M8	30	67	64	725	0.77	88.0	4.8	1.8	2.2	0.640	355
OV 250S8	37	83	79	730	0.77	88.0	4.8	1.8	2.2	0.850	420
OV 250M8	45	101	96	730	0.77	88.0	4.8	1.8	2.2	0.920	440
OV 280S8	55	120	114	730	0.77	90.5	5.5	2.0	2.5	1.800	645
OV 280M8	75	164	155	730	0.77	90.5	5.5	2.0	2.5	1.800	645
OV 315S8	90	188	179	735	0.79	92.0	6.0	1.7	3.0	3.956	870
OV 315M8	110	226	215	735	0.8	92.5	6.0	1.7	3.0	5.125	955
OV 315MX8	132	271	257	735	0.8	92.5	6.0	1.7	3.0	5.983	970
OV 315L8	160	313	298	735	0.83	93.5	5.8	1.3	2.3	6.865	1060
OV 315LX8	200	398	379	735	0.82	93.0	5.5	1.2	2.2	7.895	1110
OV 315LY8	225	446	424	735	0.82	93.5	5.8	1.3	2.3	8.354	1280
OV 355M8	250	525	499	742	0.77	94.0	5.0	1.4	2.0	9.540	1760
OV 355MX8	280	585	555	742	0.77	94.5	5.0	1.4	2.0	10.97	1925
OV 355L8	315	641	609	742	0.79	94.5	5.0	1.4	2.0	12.51	2080

Frame size Taille	Poles	Mounting dimensions (mm) Dimensions (mm)																		
		A	B1	B2	B3	C	D	E	F	G	H	K	AB	AC	HD	BB	LD	HA	AA	L
160M L	2 4 6 8	254	210	254	-	108	48	110	14	43	160	14	292	345	445	306	191	24	45	640
180M L	2 4 6 8	279	241	279	-	121	55	110	16	49	180	15	350	380	485	335	262	30	65	775
200M L	2 4 6 8	318	267	305	-	133	60	140	18	53	200	19	392	445	550	375	287	30	70	805
225M	2	356	311	-	-	149	60	140	18	53	225	19	445	475	630	387	318	35	75	885
225M	4 6 8	356	311	-	-	149	65	140	18	58	225	19	445	475	630	387	318	35	75	885
250 S M	2	406	311	349	-	168	65	140	18	58	250	24	492	520	730	425	332	40	85	960
250S M	4 6 8	406	311	349	-	168	75	140	20	68	250	24	492	520	730	425	332	40	85	960
280S M	2	457	368	419	-	190	65	140	18	58	280	24	555	585	785	490	369	45	95	1060
280S M	4 6 8	457	368	419	-	190	80	170	22	71	280	24	555	585	785	490	369	45	95	1090
315(A)	2	508	406	457	508	216	70	140	20	63	315	28	620	665	875	615	458	50	110	1260
315(A)	4 6 8	508	406	457	508	216	90	170	25	81	315	28	620	665	875	615	458	50	110	1295
315(B)	2	508	406	457	508	216	80	170	22	71	315	28	620	665	875	800	458	50	110	1455
315(B)	4 6 8	508	406	457	508	216	90	170	25	81	315	28	620	665	875	800	458	50	110	1490
355M L	2	610	500	560	630	254	80	170	22	71	355	24	740	768	1085	760	569	55	120	1628
355M L	4 6 8	610	500	560	630	254	100	210	28	90	355	24	740	768	1085	760	569	55	120	1670

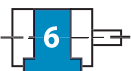
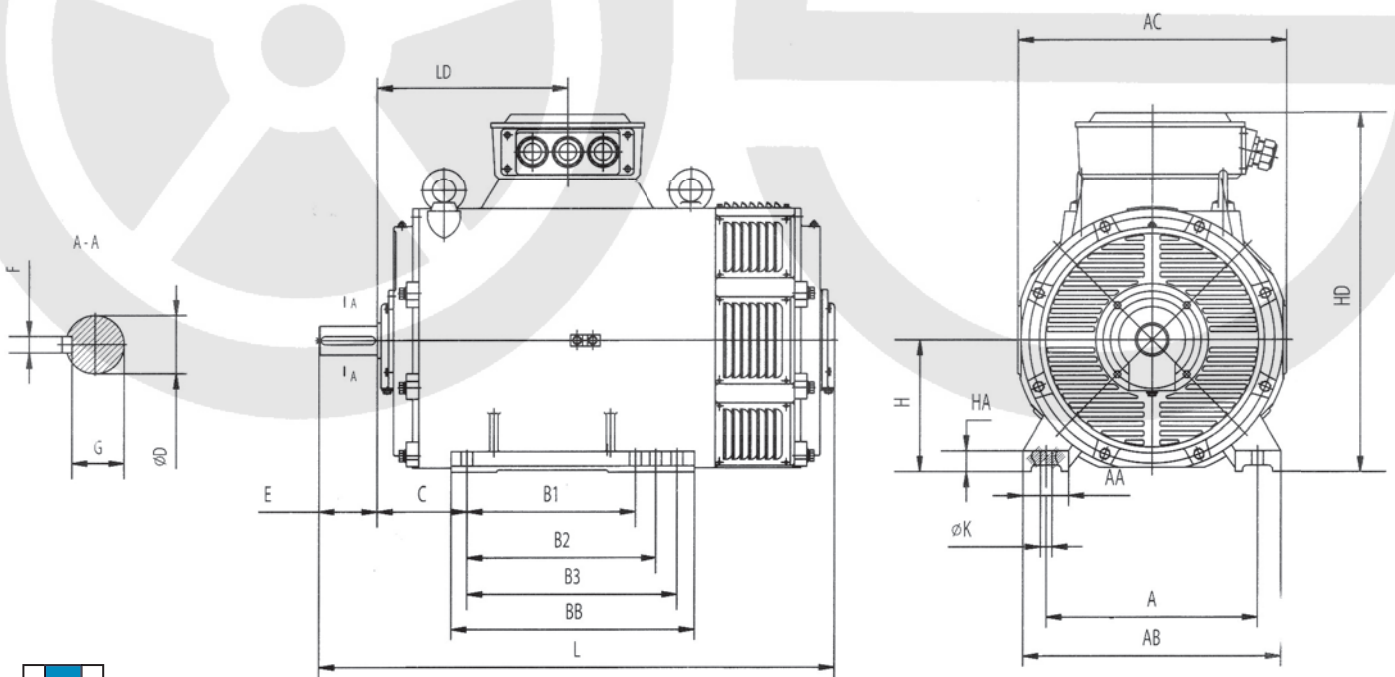

Frame size Taille	Poles	Mounting dimensions (mm) Dimensions (mm)																			
		A	B1	B2	B3	C	D	E	F	G	H	K	M	N	P	S	T	AB	AC	HD	L
160M L	2 4 6 8	254	210	254	-	108	48	110	14	42.5	160	14	300	250	350	4 19	5	292	345	445	640
180M L	2 4 6 8	279	241	279	-	121	55	110	16	49	180	15	350	300	400	4 19	5	350	380	485	755
200M L	2 4 6 8	318	267	305	-	133	60	140	18	53	200	19	400	350	450	8 19	5	392	445	550	805
225M	2	356	311	-	-	149	60	140	18	53	225	19	500	450	550	8 19	5	445	475	630	885
225M	4 6 8	356	311	-	-	149	65	140	18	58	225	19	500	450	550	8 19	5	445	475	630	885
250S M	2	406	311	349	-	168	65	140	18	58	250	24	600	550	660	8 24	6	492	520	730	960
250S M	4 6 8	406	311	349	-	168	75	140	20	67.5	250	24	600	550	660	8 24	6	492	520	730	960
280S M	2	457	368	419	-	190	65	140	18	58	280	24	600	550	660	8 24	6	555	585	785	1060
280S M	4 6 8	457	368	419	-	190	80	170	22	71	280	24	600	550	660	8 24	6	555	585	785	1090
315(A)	2	508	406	457	508	216	70	140	20	62.5	315	28	740	680	800	8 24	6	620	665	875	1260
315(A)	4 6 8	508	406	457	508	216	90	170	25	81	315	28	740	680	800	8 24	6	620	665	875	1295
315(B)	2	508	457	508	560	216	80	170	22	71	315	28	740	680	800	8 24	6	620	665	875	1455
315(B)	4 6 8	508	457	508	560	216	90	170	25	81	315	28	740	680	800	8 24	6	620	665	875	1490
355M L	2	610	500	560	630	254	80	170	22	71	355	24	940	880	1000	8 20	6	740	768	1085	1628
355M L	4 6 8	610	500	560	630	254	100	210	28	90	355	24	940	880	1000	8 20	6	740	768	1085	1670

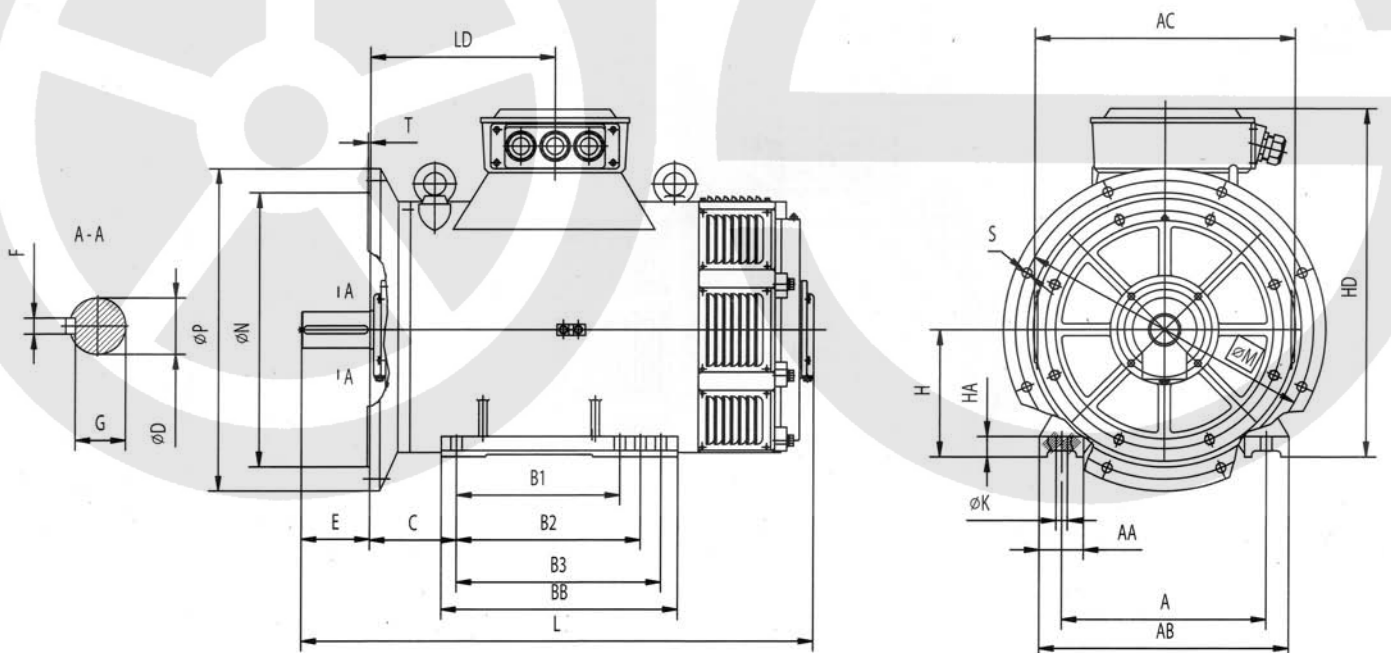

B5 (V1)

Frame size Taille	Poles	Mounting dimensions (mm) Dimensions (mm)												
		D	E	F	G	H	M	N	P	S	T	AC	HD	L
160M L	2 4 6 8	48	110	14	42.5	160	300	250	350	4-19	5	352	436	632
180M L	2 4 6 8	55	110	16	49	180	350	300	400	4-19	5	488	490	740
200M L	2 4 6 8	60	140	18	53	200	400	350	450	8-19	5	545	540	800
225M	2	60	140	18	53	225	500	450	550	8-19	5	615	590	890
225M	4 6 8	65	140	18	58	225	500	450	550	8-19	5	615	590	890
250 S M	2	65	140	18	58	250	600	550	660	8-24	6	665	660	960
250S M	4 6 8	75	140	20	67.5	250	600	550	660	8-24	6	665	660	960
280S M	2	65	140	18	58	280	600	550	660	8-24	6	740	750	1056
280S M	4 6 8	80	170	22	71	280	600	550	660	8-24	6	740	750	1086
315(A)	2	70	140	20	62.5	315	740	680	800	8-24	6	900	875	1420
315(A)	4 6 8	90	170	25	81	315	740	680	800	8-24	6	900	875	1455
315(B)	2	80	140	22	70	315	740	680	800	8-24	6	900	875	1595
315(B)	4 6 8	90	170	25	81	315	740	680	800	8-24	6	900	875	1630
355M L	2	80	170	22	71	355	940	880	1000	8-20	6	723	1228	1628
355M L	4 6 8	100	210	28	90	355	940	880	1000	8-20	6	723	1228	1670

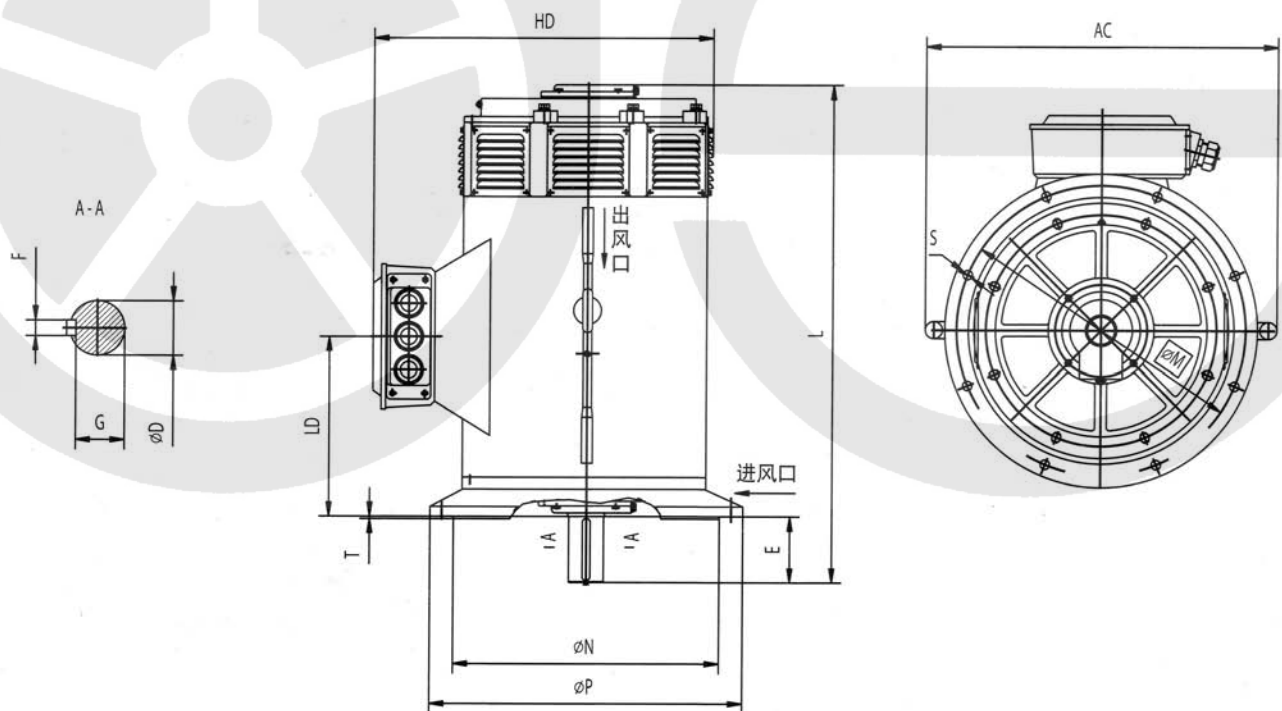

Frame size Taille	X	Y	Z	Dia. Of the pipe thread Diamètre des P. E.
160M L	200	250	115	2-M50x1.5
180M L	200	250	115	2-M50x1.5
200M L	226	280	123	2-M63x1.5
225M	226	280	123	2-M63x1.5
250S M	303	335	166	2-M63x1.5
280S M	370	470	170	2-M63x1.5
315S M L	370	470	170	2-M63x1.5
355S M L	430	560	240	2-M63x1.5

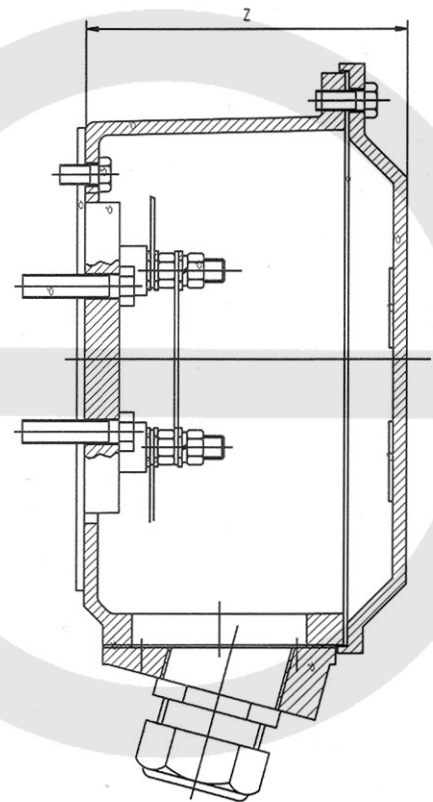
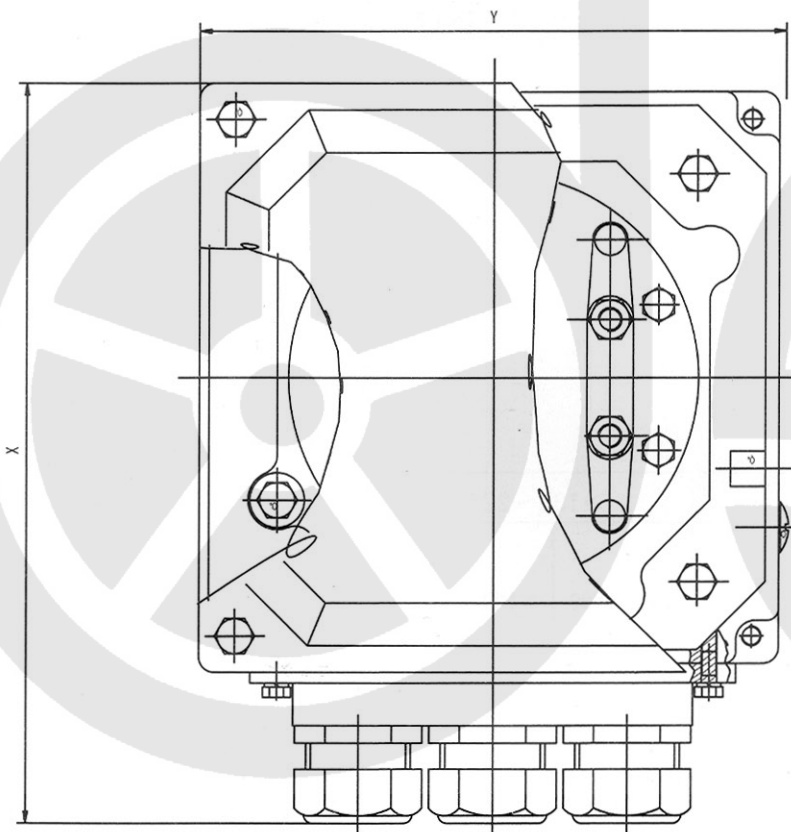

Bearings - Roulements

Size Tailles	B3, B35, B5			
	Driving End Côté axe		Non-driving End opposé à l'axe	
	2(pole)	4. 6. 8.(pole)	2(pole)	4. 6. 8.(pole)
160	6310C3	6310C3	6310C3	6310C3
180	6312C3	6312C3	6312C3	6312C3
200	6313C3	6313C3	6313C3	6313C3
225	6314C3	6314C3	6314C3	6314C3
250	6314C3	6317C3	6314C3	6317C3
280	6314C3	6318C3	6314C3	6318C3
315	6317C3	6319C3(N319)	6317C3	6319C3
355	6319C3	6322C3(N322)	6319C3	6320C3

Frame size	V1			
	Driving End Côté axe		Non-driving End opposé à l'axe	
	2(pole)	4. 6. 8.(pole)	2(pole)	4. 6. 8.(pole)
315	6317C3	6319C3(N319)	7317	7319
355	6319C3	6322C3(N322)	7319	7320

Vibration

Size Tailles	≤ 132		>132 - 225		> 225 ~ 400		
	Synchronous speed r/min	600~1800	>1800~3600	600~1800	>1800~3600	500 ~ 1800	>1800 ~ 3600
Vibration Class	Effective Value of speed mm/s						
N		1.8		2.8		3.5	
R	0.71	1.12	1.12	1.80	1.80	2.80	
S	0.45	0.71	0.71	1.12	1.12	1.80	

Noise - Bruit (50Hz)

Output Sortie (kW)	Synchronous speed r/min			
	3000	1500	1000	750
	Lp dB(A) Sound pressure level in dB(A)			
	no load	no load	no load	no load
11	-	66	63	62
15	72	66	63	62
18.5	72	66	63	63
22	72	67	65	63
30	77	67	65	64
37	77	68	67	65
45	81	68	68	65
55	81	70	68	67
75	82	73	70	67
90	83	73	70	70
110	83	74	73	70
132	83	74	73	70
160	88	81	76	72
180	-	-	76	-
200	88	81	76	72
225	-	-	76	72
250	88	85	76	73
280	88	85	76	73
315	88	85	76	73
355	88	85	76	-
400	88	85	76	-
450	88	-	76	-
500	88	85	76	-
560	-	85	-	-
630	89	85	-	-
710	89	85	-	-